



# Scantling

## Mathias Hahn

**marset**

Wood and metal combine in a design that utilizes the beauty and simplicity of basic geometric shapes. The Scantling is based on a highly functional and flexible system, in which all the movements of the fully rotational shade use ball

joints and arms to create a versatile, easy-to-move light. In addition, its technical precision requires no exposed springs or counterweights to stay in the specified position.



**Scantling A**

Code  
A626-015

Finish  
● White (RAL 9001)

Socket: E26  
Suggested lamping: LED TYPE A, 11W max  
Lamping not included

Dimmable: No

Materials  
Base: Iron  
Arm: Oak  
Shade: Aluminum

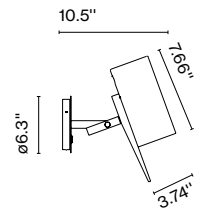

**⚠ WARNING.** California Proposition 65 Warning for California Consumers. This product can expose you to chemicals including wood dust and lead which are known to the State of California to cause cancer or birth defects or other reproductive harm. For more information go to [www.P65Warnings.ca.gov](http://www.P65Warnings.ca.gov)

**Video** [marsetusa@marset.com](mailto:marsetusa@marset.com)  
[www.marset.com](http://www.marset.com)

**Download** Photometric data file (LDT or IES)  
2D, 3D, Photometric Data  
Assembly instructions