



# Ringo

## Joan Gaspar

**marset**

Bold, transparent and organic. A rounded geometric shape that resembles a great block of ice. This lamp, designed for large spaces, is surprising for its material, a transparent polycarbonate capable of creating optical reflections. Contrasting

interplay between light and matter, forcefulness and lightness, presence and transparency.



### Ringo 70 C Fixed Stem

Code	Finish
A732-103-53-3CCT	Smoked
A732-103-62-3CCT	Dark smoked
A732-103-63-3CCT	Rosé
A732-103-57-3CCT	Green

The 3-CCT model has an integrated switch to select the desired color temperature during the installation.

Dimmable: Yes  
Integrated dimmer: No  
Dimming protocols: TRI-DIM driver:  
TRIAC (min. 1%) /  
ELV / 0-10V

Materials  
Shade: Rotomoulded polycarbonate  
Diffuser: Opal methacrylate

Product Notes: LED included.  
The height can be increased by means of the 15.7 or 23.6" poles (max. 3 units).  
They can be combined.

Fixture net weight: 24.3 lb

Wire installation: Hardwired

 Dry locations only Dimmable

Electrical  
Electrical Rating: 120-277VAC 60Hz 31W  
Luminaire: 2363lm  
CCT: 2700K-3000K-4000K  
CRI: 90

Mounting plate detail:

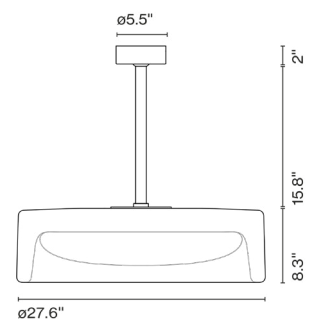
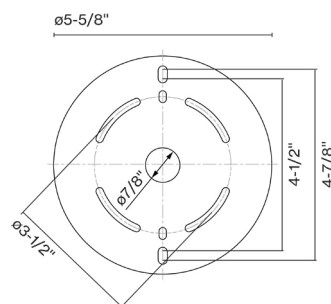

Ringo 90 C Fixed Stem

Code	Finish
A732-106-53-3CCT	Smoked
A732-106-62-3CCT	Dark smoked
A732-106-63-3CCT	Rosé
A732-106-57-3CCT	Green

The 3-CCT model has an integrated switch to select the desired color temperature during the installation.

Dimmable: Yes  
Integrated dimmer: No  
Dimming protocols: Dual dimming driver:  
ELV (min. 10%) /  
0-10V (min. 10%)

Materials  
Shade: Rotomoulded polycarbonate  
Diffuser: Opal methacrylate

Product Notes: LED included.  
The height can be increased by means of the 15.7 or 23.6" poles (max. 3 units).  
They can be combined.

Fixture net weight: 41.7 lb  
Wire installation: Hardwired

 Dry locations only

Dimmable

Electrical  
Electrical Rating: 120-277VAC 60Hz 53W  
Luminaire: 4746lm  
CCT: 2700K-3000K-4000K  
CRI: 90

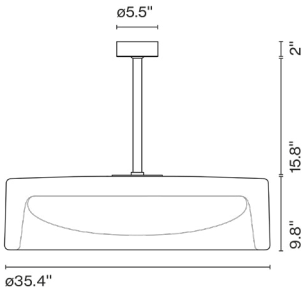
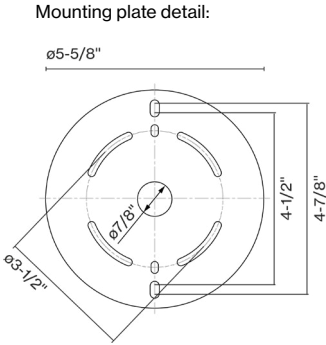

Accessories

Ringo Extension Pole 40

Code	Finish
A732-013-39	Black

Materials  
Structure: Metal



Ringo Extension Pole 60

Code	Finish
A732-014-39	Black

Materials  
Structure: Metal



**⚠ WARNING.** California Proposition 65 Warning for California Consumers. This product can expose you to chemicals including wood dust and lead which are known to the State of California to cause cancer or birth defects or other reproductive harm. For more information go to [www.P65Warnings.ca.gov](http://www.P65Warnings.ca.gov)

[marsetusa@marset.com](mailto:marsetusa@marset.com)  
[www.marset.com](http://www.marset.com)

**Download**  
Photometric data file (LDT or IES)  
2D, 3D, Photometric Data  
Assembly instructions