

Plaff-on!

Joan Gaspar

marset



Plaff-on! 50 IP54

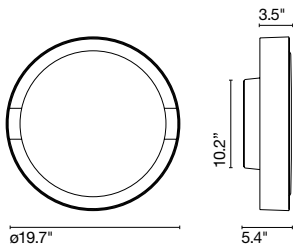

Plaff-on! 33 IP54

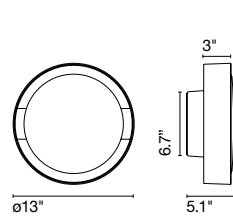

Plaff-on! 16 IP65

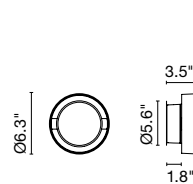

⚠ WARNING. California Proposition 65 Warning for California Consumers. This product can expose you to chemicals including wood dust and lead which are known to the State of California to cause cancer or birth defects or other reproductive harm. For more information go to www.P65Warnings.ca.gov

Plaff-on! 50

4x E26 LED TYPE A 11W

Plaff-on! 50 LED IP54

Light source:
LED SMD 700mA 29W 2700K CRI90 3318lm
Luminaire:
Only 120 VAC TRIAC 36W 2172lm
120 - 277 VAC 0-10V 36W 2172lm

For 3CCT
Light source:
LED SMD 700mA 29W 2700-4000K CRI90 3318lm
Luminaire:
Only 120 VAC TRIAC 36W 2172lm
120 - 277 VAC 0-10V 36W 2172lm

Plaff-on! 33

2x E26 LED TYPE A 11W

Plaff-on! 33 LED IP54

Light source:
LED SMD 700mA 23W 2700K CRI90 2654lm
Luminaire:
Only 120 VAC TRIAC 28W 1941lm
120 - 277 VAC 0-10V 28W 1941lm

For 3CCT
Light source:
LED SMD 700mA 23W 2700-4000K CRI90 2654lm
Luminaire:
Only 120 VAC TRIAC 28W 1941lm
120 - 277 VAC 0-10V 28W 1941lm

Plaff-on! 16 IP65

Light Source:
LED SMD 500mA 6W 2700K CRI90 607.2lm
Luminaire:
120 VAC TRIAC 8.7W 225lm

Ring made of lacquered aluminum which supports an opal blown glass shade.

Structure

● Black

Diffuser

○ White

Wall / Ceiling mount



Plaff-On! 50 IP54 and Plaff-On 33 IP54 suitable for damp locations.

Plaff-On! 50 and Plaff-On 33 suitable for dry locations.

Plaff-On! 16 IP65 suitable for wet locations.

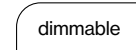

Plaff-on! 50 LED IP54

Dimming protocols: Dual dimming driver
Phase cut (Triac) or 0-10V

Plaff-on! 33 LED IP54

Dimming protocols: Dual dimming driver
Phase cut (Triac) or 0-10V

Plaff-on! 16 IP65

Dimming protocols: Phase cut (Triac)
Available upon request:
on/off
0-10V (120-277V)

A ceiling lamp whose beauty lies in its simplicity and clarity, offering multiple lighting effects thanks to its design.



Signage Lid (Available upon request)
Only available for Plaff-on! 16 IP65.

- [Download](#) Assembly Instructions
- [Download](#) Photometric Data
- [Download](#) 2D
- [Download](#) 3D