



LED - Ginger

Joan Gaspar

marset

The combination of sheets of wood, paper and resins pressed together under high pressure achieves a laminate that appears almost entirely flat, which discreetly lights up spaces with indirect light. With the introduction of new metal

shades, in black, white, or brushed brass finish, the LED - Ginger offers the same warm, glare-free light to help emphasize your spaces. These metal shades offer a more refined option that is almost sculptural in its appearance.



LED - Ginger 20C

Code	Finish
A662-288	● Oak-White
A662-289	● Wenge-White
A662-290	● Oak-Oak
A662-291	● Wenge-Wenge
A662-292	● Brushed brass-Brushed brass
A662-293	● Black-White
A662-576-36-27K	● MaLive (RAL 010 70 10)
A662-576-37-27K	● Sand (RAL 050 85 10)
A662-576-38-27K	● Stone Grey (RAL 000 65 00)

Electrical
 Electrical Rating: 120-240VAC 50-60Hz 6W
 Luminaire: 161lm
 CCT: 2700K
 CRI: 90

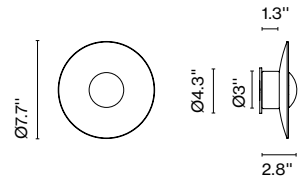

Dimmable: Not dimmable

Materials

Diffuser: Pressed wood or brushed aluminum
 Dissipater: Aluminum
 Canopy: Metal

Dry locations only

LED included



LED - Ginger 32C

Code	Finish	Dimming	Electrical
A662-203	● Oak-White	ELV	ELV
A662-204	● Wenge-White	ELV	Electrical Rating: 100-120VAC 50-60Hz 14W
A662-205	● Oak-Oak	ELV	Luminaire: 350lm
A662-206	● Wenge-Wenge	ELV	CCT: 2700K
A662-294	● Brushed brass	ELV	CRI: 90
A662-295	● Black-White	ELV	
A662-577-36-27K	● Mauve (RAL 010 70 10)	ELV	
A662-577-37-27K	● Sand (RAL 050 85 10)	ELV	
A662-577-38-27K	● Stone Grey (RAL 000 65 00)	ELV	
A662-324	● Oak-White	0-10V	0-10V
A662-325	● Wenge-White	0-10V	Electrical Rating: 120-277VAC 50-60Hz 14W
A662-326	● Oak-Oak	0-10V	Luminaire: 350lm
A662-327	● Wenge-Wenge	0-10V	CCT: 2700K
A662-296	● Brushed brass	0-10V	CRI: 90
A662-297	● Black-White	0-10V	
A662-578-36-27K	● Mauve (RAL 010 70 10)	0-10V	
A662-578-37-27K	● Sand (RAL 050 85 10)	0-10V	
A662-578-38-27K	● Stone Grey (RAL 000 65 00)	0-10V	

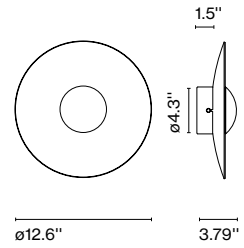

Dimmable: Yes
 Integrated dimmer: No
 Dimming protocols: Phase cut (ELV), 0-10V

Materials
 Diffuser: Pressed wood or brushed aluminum
 Dissipater: Aluminum
 Canopy: Metal

Dry locations only

LED included



LED - Ginger 42C

Code	Finish	Dimming	Electrical
A662-207	● Oak-White	ELV	ELV
A662-208	● Wenge-White	ELV	Electrical Rating: 90-135VAC 50-60Hz 21W
A662-209	● Oak-Oak	ELV	Luminaire: 698lm
A662-210	● Wenge-Wenge	ELV	CCT: 2700K
A662-446	● Brushed brass	ELV	CRI: 90
A662-447	● Black-White	ELV	
A662-579-36-27K	● Mauve (RAL 010 70 10)	ELV	
A662-579-37-27K	● Sand (RAL 050 85 10)	ELV	
A662-579-38-27K	● Stone Grey (RAL 000 65 00)	ELV	
A662-328	● Oak-White	0-10V	0-10V
A662-329	● Wenge-White	0-10V	Electrical Rating: 120-277VAC 50-60Hz 21W
A662-330	● Oak-Oak	0-10V	Luminaire: 698lm
A662-331	● Wenge-Wenge	0-10V	CCT: 2700K
A662-448	● Brushed brass	0-10V	CRI: 90
A662-449	● Black-White	0-10V	
A662-580-36-27K	● Mauve (RAL 010 70 10)	0-10V	
A662-580-37-27K	● Sand (RAL 050 85 10)	0-10V	
A662-580-38-27K	● Stone Grey (RAL 000 65 00)	0-10V	

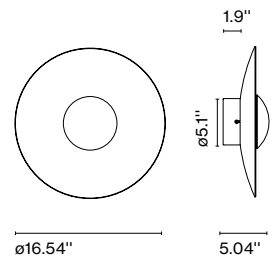

Dimmable: Yes
 Integrated dimmer: No
 Dimming protocols: Phase cut (ELV), 0-10V

Materials
 Diffuser: Pressed wood or brushed aluminum
 Dissipater: Aluminum
 Canopy: Metal

Dry locations only

LED included



LED - Ginger 60C

Code	Finish
A662-332	● Oak-White
A662-333	● Wenge-White
A662-334	● Oak-Oak
A662-335	● Wenge-Wenge
A662-450	● Brushed brass
A662-451	● Black-White
A662-581-36-27K	● Mauve (RAL 010 70 10)
A662-581-37-27K	● Sand (RAL 050 85 10)
A662-581-38-27K	● Stone Grey (RAL 000 65 00)

Electrical
 Dual dimming
 ELV: 120VAC 50-60Hz 28W
 0-10V: 120-277VAC 50-60Hz 28W

Luminaire: 1165lm
 CCT: 2700K
 CRI: 90

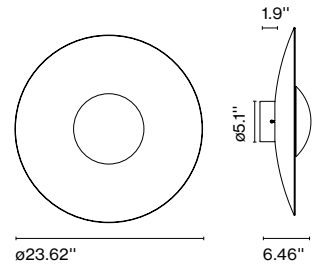

Dimmable: Yes
 Integrated dimmer: No
 Dimming protocols: Dual dimming driver
 Dual ELV +0-10V Dimming

Materials
 Diffuser: Pressed wood or brushed aluminum
 Dissipater: Aluminum
 Canopy: Metal

Dry locations only

LED included



Ginger Cluster Installations

Use the codes below to install numerous Ginger fixtures to a single junction box. Each accessory must be combined with the requisite shades.

To create clusters in these sizes, combine these accessories with the fixture codes starting on page 3 of this data sheet.

Accessory C2 LED-Ginger 32/42

Code A662-215 Finish ● Black (RAL 9005)

Materials
Structure: Painted iron

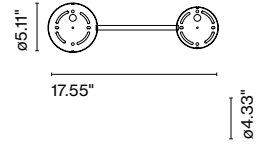

Accessory C2 LED-Ginger 42/60

Code A662-273 Finish ● Black (RAL 9005)

Materials
Structure: Painted iron

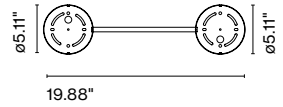

Accessory C3 LED-Ginger 32/42/60

Code A662-216 Finish ● Black (RAL 9005)

Materials
Structure: Painted iron

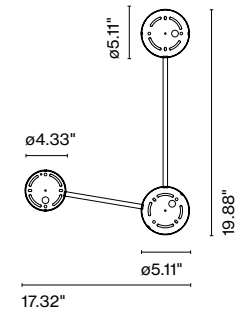

Accessory C3 20/32

Code	Finish	Electrical
Structure		ELV: 120VAC 50-60Hz 20W
A662-518	● Black	0-10V: 120-277VAC 50-60Hz 20W

Shades 20

A662-519	● Oak-White
A662-520	● Wenge-White
A662-521	● Oak-Oak
A662-522	● Wenge-Wenge
A662-523	● Brushed brass
A662-524	● Black and white
A662-582-36-27K	● Mauve (RAL 010 70 10)
A662-582-37-27K	● Sand (RAL 050 85 10)
A662-582-38-27K	● Stone Grey (RAL 000 65 00)

Shades 32

A662-525	● Oak-White
A662-526	● Wenge-White
A662-527	● Oak-Oak
A662-528	● Wenge-Wenge
A662-529	● Brushed brass
A662-530	● Black-White
A662-583-36-27K	● Mauve (RAL 010 70 10)
A662-583-37-27K	● Sand (RAL 050 85 10)
A662-583-38-27K	● Stone Grey (RAL 000 65 00)

Dimmable: Yes
 Integrated dimmer: No
 Dimming protocols: Dual dimming driver
 Dual ELV +0-10V Dimming

Materials
 Canopy: Metal

Dry locations only

LED included

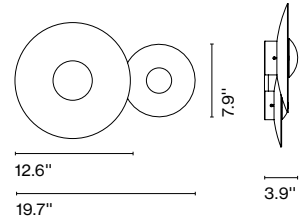

Accessory C2 20/32/42

Code Structure A662-539
 Finish ● Black
 Electrical ELV: 120VAC 50-60Hz 30W
 0-10V: 120-277VAC 50-60Hz 30w

Shades 20
 A662-519 ● Oak-White
 A662-520 ● Wenge-White
 A662-521 ● Oak-Oak
 A662-522 ● Wenge-Wenge
 A662-523 ● Brushed brass
 A662-524 ● Black and white
 A662-582-36-27K ● Mauve (RAL 010 70 10)
 A662-582-37-27K ● Sand (RAL 050 85 10)
 A662-582-38-27K ● Stone Grey (RAL 000 65 00)

Shades 32
 A662-525 ● Oak-White
 A662-526 ● Wenge-White
 A662-527 ● Oak-Oak
 A662-528 ● Wenge-Wenge
 A662-529 ● Brushed brass
 A662-530 ● Black-White
 A662-583-36-27K ● Mauve (RAL 010 70 10)
 A662-583-37-27K ● Sand (RAL 050 85 10)
 A662-583-38-27K ● Stone Grey (RAL 000 65 00)

Shades 42
 A662-532 ● Oak-White
 A662-533 ● Wenge-White
 A662-534 ● Oak-Oak
 A662-535 ● Wenge-Wenge
 A662-536 ● Brushed brass
 A662-537 ● Black-White
 A662-584-36-27K ● Mauve (RAL 010 70 10)
 A662-584-37-27K ● Sand (RAL 050 85 10)
 A662-584-38-27K ● Stone Grey (RAL 000 65 00)

Dimmable: Yes
 Integrated dimmer: No
 Dimming protocols: Dual dimming driver
 Dual ELV +0-10V Dimming

Materials
 Canopy: Metal

Dry locations only

LED included

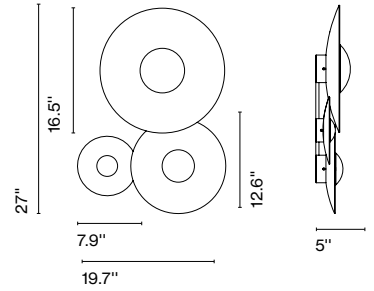

⚠ WARNING. California Proposition 65 Warning for California Consumers. This product can expose you to chemicals including wood dust and lead which are known to the State of California to cause cancer or birth defects or other reproductive harm. For more information go to www.P65Warnings.ca.gov

marsetusa@marset.com
 www.marset.com

Download Photometric data file (LDT or IES)
 2D, 3D, Photometric Data
 Assembly instructions

Collection

