



Ambrosia

Ciszak Dalmas

marset

Its design stems from a tubular structure with gentle lines that attaches to the ceiling, allowing the light to descend and gently illuminate any type of project. It is this diffuse light that fills the space, adding beauty.

Its linear and unique design, a nearly flat segment of light, was made modular and asymmetric to create a soft and surprising lighting system.



Ambrosia 120

Code	Finish	Electrical Rating	Luminaire	CCT	CRI
A704-101-15-22K	● Matt Gold	24Vdc 19.2W	1885lm	2200K	CRI90
A704-101-15-27K	● Matt Gold	24Vdc 19.2W	1891lm	2700K	CRI90
A704-101-15-30K	● Matt Gold	24Vdc 19.2W	1927lm	3000K	CRI90
A704-101-16-22K	● Black	24Vdc 19.2W	1885lm	2200K	CRI90
A704-101-16-27K	● Black	24Vdc 19.2W	1891lm	2700K	CRI90
A704-101-16-30K	● Black	24Vdc 19.2W	1927lm	3000K	CRI90

Dimmable: Based on specified driver

Integrated dimmer: No

Dimming protocols: Based on specified driver

Materials

Structure: Aluminum

Diffuser: Methacrylate

Canopy: Aluminum / Steel

Suitable for Damp Locations

LED included



Dimmable

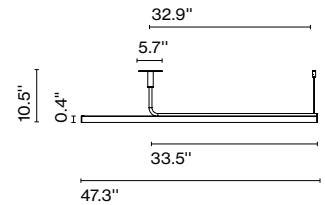

"(f) The height can be increased by means of the 15.7 or 23.6" poles (max. 3 units.) They can be combined."

Ambrosia 180

Code	Finish	Electrical Rating	Luminaire	CCT	CRI
A704-102-15-22K	● Matt Gold	24Vdc 28.8W	2823lm	2200K	CRI90
A704-102-15-27K	● Matt Gold	24Vdc 28.8W	2833lm	2700K	CRI90
A704-102-15-30K	● Matt Gold	24Vdc 28.8W	2886lm	3000K	CRI90
A704-102-16-22K	● Black	24Vdc 28.8W	2823lm	2200K	CRI90
A704-102-16-27K	● Black	24Vdc 28.8W	2833lm	2700K	CRI90
A704-102-16-30K	● Black	24Vdc 28.8W	2886lm	3000K	CRI90

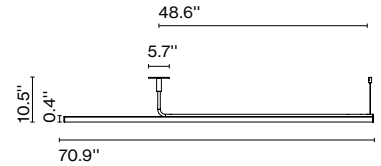

Dimmable: Based on specified driver
 Integrated dimmer: No
 Dimming protocols: Based on specified driver

Materials
 Structure: Aluminum
 Diffuser: Methacrylate
 Canopy: Aluminum / Steel

Suitable for Damp locations

LED included



Ambrosia 210

Code	Finish	Electrical Rating	Luminaire	CCT	CRI
A704-103-15-22K	● Matt Gold	24Vdc 28.8W	2802lm	2200K	CRI90
A704-103-15-27K	● Matt Gold	24Vdc 28.8W	2812lm	2700K	CRI90
A704-103-15-30K	● Matt Gold	24Vdc 28.8W	2865lm	3000K	CRI90
A704-103-16-22K	● Black	24Vdc 28.8W	2802lm	2200K	CRI90
A704-103-16-27K	● Black	24Vdc 28.8W	2812lm	2700K	CRI90
A704-103-16-30K	● Black	24Vdc 28.8W	2865lm	3000K	CRI90

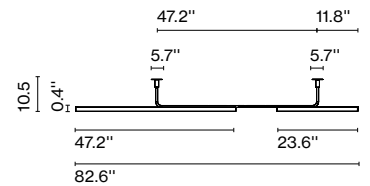

Dimmable: Based on specified driver
 Integrated dimmer: No
 Dimming protocols: Based on specified driver

Materials
 Structure: Aluminum
 Diffuser: Methacrylate
 Canopy: Aluminum / Steel

Suitable for Damp locations

LED included

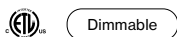

“(f) The height can be increased by means of the 15.7 or 23.6 “poles (max. 3 units.) They can be combined.”

Ambrosia 315

Code	Finish	Electrical Rating	Luminaire	CCT	CRI
A704-104-15-22K	● Matt Gold	24Vdc 43.2W	4220lm	2200K	CRI90
A704-104-15-27K	● Matt Gold	24Vdc 43.2W	4235lm	2700K	CRI90
A704-104-15-30K	● Matt Gold	24Vdc 43.2W	4314lm	3000K	CRI90
A704-104-16-22K	● Black	24Vdc 43.2W	4220lm	2200K	CRI90
A704-104-16-27K	● Black	24Vdc 43.2W	4235lm	2700K	CRI90
A704-104-16-30K	● Black	24Vdc 43.2W	4314lm	3000K	CRI90

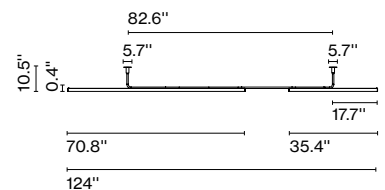

Dimmable: Based on specified driver
 Integrated dimmer: No
 Dimming protocols: Based on specified driver

Materials
 Structure: Aluminum
 Diffuser: Methacrylate
 Canopy: Aluminum / Steel

Suitable for Damp locations

LED included



“(f) The height can be increased by means of the 15.7 or 23.6 “poles (max. 3 units.) They can be combined.”

Accessories guide

The Ambrosia offers numerous powering options, as well as extension poles to increase the fixture drop. If chosen, the items below should be selected at time of specification.

The Ambrosia 120 and 180 have a rigid stem on one end, so can accommodate a maximum of three height extension poles of either size. The Ambrosia 210 and 315 have rigid stems on both ends, so can accommodate a maximum of six height extension poles of either size (three per end). Default drop length for all Ambrosia fixtures, without extension poles, is 10.5 inches. Maximum drop length, utilizing three 23.6-inch poles per end, is 81.3 inches.

Power supplies for this fixture are sold separately. The all-in-one solution for power is the Canopy (A666-213-1*), which contains the 60W 0-10V driver and mounts over a junction box.

For recessed or remote-driver installation, select only the Power Supply (968-230), and Outlet Box Cover Plate (A666-219-1*).

Alternately, the fixture can be powered by a UL/ETL-certified 24V power supply from a third-party supplier.

Height extension pole 16

Code	Finish
A704-005-15	● Matt Gold
A704-005-16	● Black

Materials
Structure: Metal



Height extension pole 24

Code	Finish
A704-006-15	● Matt Gold
A704-006-16	● Black

Materials
Structure: Metal



Canopy Ambrosia 60W

Code	Finish	Dimming
A666-213-15	● Matt Gold - 60W 24V	0-10V
A666-213-16	● Black - 60W 24V	0-10V

Materials
Structure: Metal
Dimmable: Yes
Integrated dimmer: No
Dimming protocols: 0-10V
INPUT: 120-277 VAC 50/60Hz
OUTPUT: CV 24V DC 60W max.

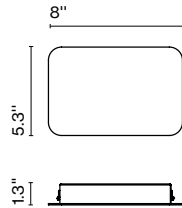

Code	Finish	Dimming
A666-254-15	● Matt Gold - 60W 24V	ELV / Triac / 0-10V
A666-254-16	● Black - 60W 24V	ELV / Triac / 0-10V

Materials
Structure: Metal
Dimmable: Yes
Integrated dimmer: No
Dimming protocols: 0-10V
INPUT: 120-277 VAC 50/60Hz
OUTPUT: CV 24V DC 60W max.

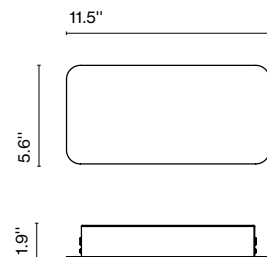

Outlet Box Cover Plate

Code	Finish
A666-219-15	● Matt Gold
A666-219-16	● Black

Product type: Accessory
Product notes: Ceiling cover plate for 4" octagonal junction box.

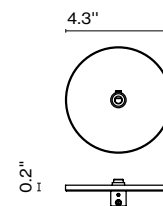

Power supply - Dimmable

Code	Description	Dimming
A968-373	96W - 24V	TRI-DIM (Triac / ELV, 0-10V)

Product type: Power supply
 INPUT: 120-277 VAC 50/60Hz
 OUTPUT: CV 24V DC 96W max.

Code	Description	Dimming
968-230	60W - 24V	0-10V

Product type: Power supply
 INPUT: 120-277 VAC 50/60Hz
 OUTPUT: CV 24V DC 60W max.

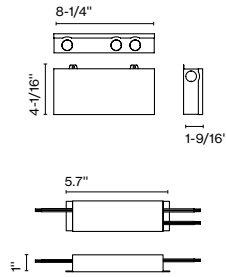

The installation and location of the remote LED driver **and any required enclosure** must be in accordance with **applicable codes and laws** and will be the exclusive responsibility of the installation company. **Marset does not provide remote driver enclosures.**



⚠ WARNING. California Proposition 65 Warning for California Consumers. This product can expose you to chemicals including wood dust and lead which are known to the State of California to cause cancer or birth defects or other reproductive harm. For more information go to www.P65Warnings.ca.gov

Watch the video marsetusa@marset.com
www.marset.com

Download Photometric data file (LDT or IES)
 2D, 3D, Photometric Data
 Assembly instructions

Collection

