

Plaff-on!

Joan Gaspar

marset

A design that combines simplicity and functionality and which in this new pendant version comes with a garland accessory allowing different lamps to be

joined to a single point of light. Finally, a neoprene cable ensures waterproofing with no deterioration. The new Plaff-on! projects the light directly downwards.



Plaff-on! 16 IP65

Code	Finish	Dimming	Electrical
A628-051	● Black (RAL 9005)	ELV	ELV
A628-079-31-27K	● Rust Brown	ELV	Electrical Rating: 120VAC 50-60Hz 8.7W
A628-079-35-27K	● White (RAL 9010)	ELV	
A628-069	● Black (RAL 9005)	0-10V	0-10V
A628-080-31-27K	● Rust Brown	0-10V	Electrical Rating: 120-277VAC 50-60Hz 8.7W
A628-080-35-27K	● White (RAL 9010)	0-10V	

Dimmable: Yes
Integrated dimmer: No
Dimming protocols: Phase cut (ELV) and 0-10V (120-277V)

Materials
Structure: Aluminium
Shade: Opal blown glass

Suitable for wet locations

LED included

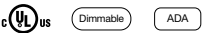

Luminaire: 225lm
CCT: 2700K
CRI: 90

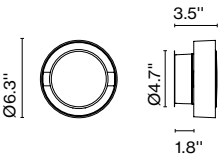

Signage Lid

Product type: Accessory
Product Notes: Minimum order of 3pcs.
Available upon request.

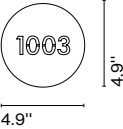

Plaff-on! 33 IP54

Code	Finish	Electrical
A628-062-3CCT	● Black	Electrical Rating: 120 VAC ELV 50-60Hz 28W
A628-062-31-3CCT	● Rust brown	120 - 277 VAC 0-10V 50-60Hz 28W
The 3-CCT model has an integrated switch to select the desired color temperature during the installation.		Luminaire: 1941lm
		CCT: 2700-3000K-4000K
		CRI: 90

Dimmable: Yes
Integrated dimmer: No
Dimming protocols: Dual dimming driver
Phase cut ELV or 0-10V

Materials
Structure: Aluminium
Shade: Opal blown glass

Suitable for damp locations

LED included

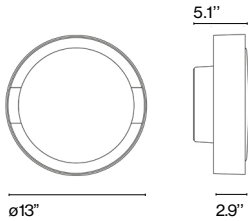

Plaff-on! 33

Code	Finish	Electrical
A628-059	● Black	Socket: 2xE26
A628-059-31	● Rust brown	Suggested lamping: LED TYPE A, 11W max
Dimmable: Yes		Lamping not included
Integrated dimmer: No		
Dimming protocols: Based on specified lamping		

Materials
Structure: Aluminium
Shade: Opal blown glass

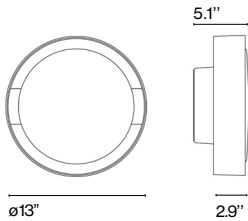

Plaff-on! 50 IP54

Code	Finish	Electrical
A628-063-3CCT	● Black	Electrical Rating: 120 VAC ELV 50-60Hz 36W
A628-063-31-3CCT	● Rust brown	120 - 277 VAC 0-10V 50-60Hz 36W
The 3-CCT model has an integrated switch to select the desired color temperature during the installation.		Luminaire: 2172lm
		CCT: 2700-3000K-4000K
		CRI: 90

Dimmable: Yes
Integrated dimmer: No
Dimming protocols: Dual dimming driver
Phase cut ELV or 0-10V

Materials
Structure: Aluminium
Shade: Opal blown glass

Suitable for damp locations

LED included

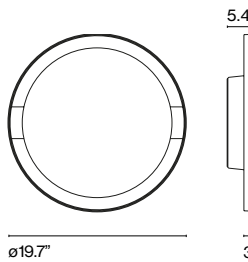

Plaff-on! 50

Code	Finish	Electrical
A628-060	● Black	Socket: 4xE26
A628-060-31	● Rust brown	Suggested lamping: LED TYPE A, 11W max
		Lamping not included
Dimmable: Yes		
Integrated dimmer: No		
Dimming protocols: Based on specified lamping		

Materials

Structure: Aluminium

Shade: Opal blown glass

Suitable for damp locations

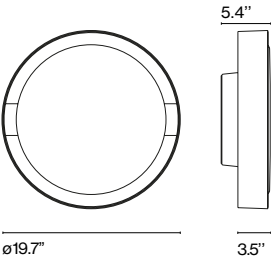

⚠ WARNING. California Proposition 65 Warning for California Consumers. This product can expose you to chemicals including wood dust and lead which are known to the State of California to cause cancer or birth defects or other reproductive harm. For more information go to www.P65Warnings.ca.gov

Download

- marsetusa@marset.com
- www.marset.com
- [Photometric data file \(LDT or IES\)](#)
- [2D, 3D, Photometric Data](#)
- [Assembly instructions](#)

