

Datos Técnicos

Luminaria para uso interior
Factor de Potencia: 1
Lámpara a utilizar:

Nenúfar Pre-set 9A (243W)
9 x Nenúfar 3

Input rating 292W

Nenúfar Pre-set 9B (162W)
3 x Nenúfar 1
3 x Nenúfar 2
3 x Nenúfar 3

Input rating 195W

Se recomienda que la instalación sea realizada por un profesional.

Aviso: Si el cable flexible o cordón de esta luminaria está dañado, deberá sustituirse exclusivamente por el fabricante o su servicio técnico o una persona de cualificación equivalente con objeto de evitar cualquier riesgo.

Instrucciones para la limpieza

Utilizar un paño suave, humedecido con agua y detergente neutro si fuera necesario. No utilizar alcohol o otros disolventes.

Technical Data

Light fitting for indoor use only
Power Factor: 1
Bulb to be used:

Nenúfar Pre-set 9A (243W)
9 x Nenúfar 3

Input rating 292W

Nenúfar Pre-set 9B (162W)
3 x Nenúfar 1
3 x Nenúfar 2
3 x Nenúfar 3

Input rating 195W

It is recommended that a professional electrician be responsible for installing the light.

Warning: If the wire or flexible cord is damaged, it must only be changed by the manufacturer, their Service Dept. or qualified personnel in order to avoid risk.

Cleaning Instructions

Use a soft damp cloth, with soap or neutral detergent. Do not use alcohol or other solvents.

DIMMABLE 3-WIRE type PWM dimming 120-277V



Este símbolo en su equipo o embalaje indica que el presente producto no puede ser tratado como residuo doméstico normal, sino que debe entregarse en el correspondiente punto de recogida de equipos eléctricos y electrónicos. Para recibir información detallada sobre el reciclaje de este producto, por favor, contacte con su ayuntamiento, su punto de recogida más cercano o el distribuidor donde adquirió el producto.

This symbol on the product or its packaging indicates that it must not be treated as household waste. It should, in fact, be handed in at a recognised collection point for recycling electrical and electronic equipment. For more detailed information about the recycling of this product, please contact your local city office, your household waste disposal service or the shop where you purchased the product.

120 -277V - 50/60 Hz

marset

NENÚFAR PRE-SET 9

3-wire dimmable

Instrucciones de montaje / Assembly Instructions

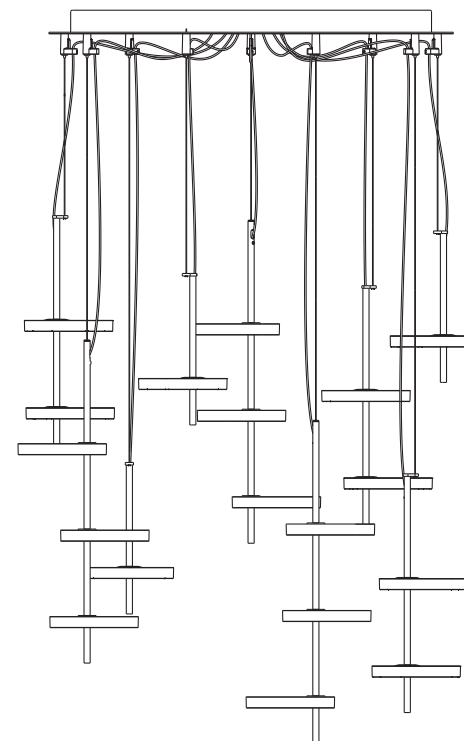

marset

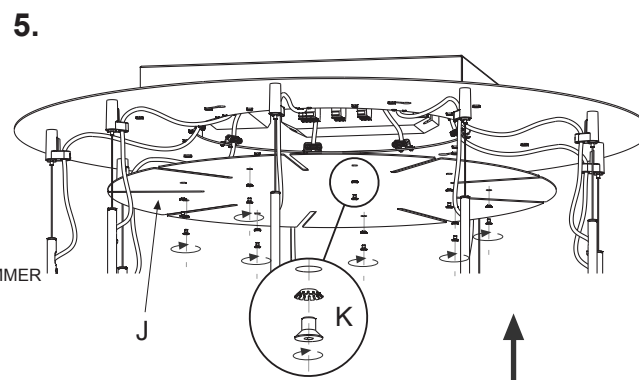
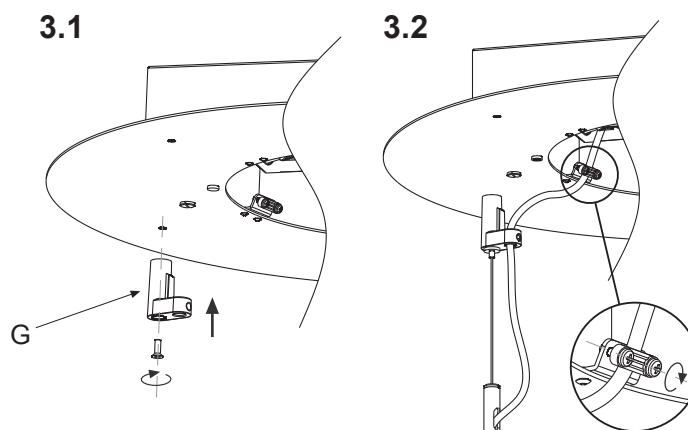
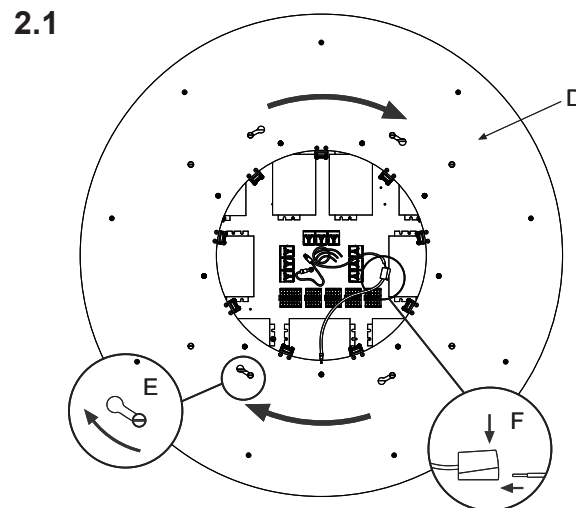
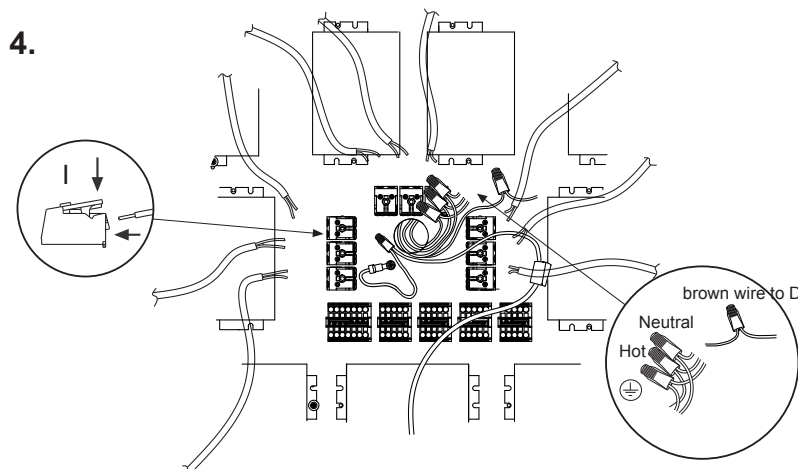
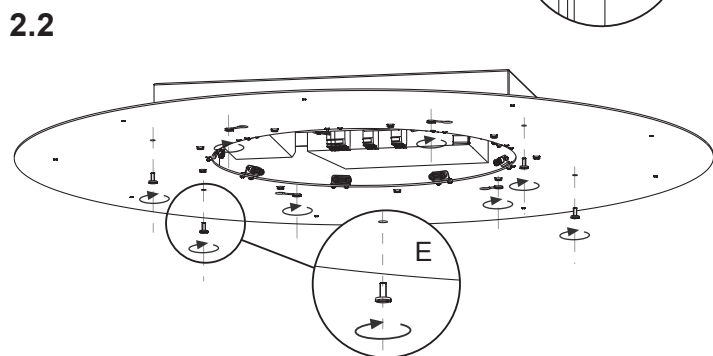
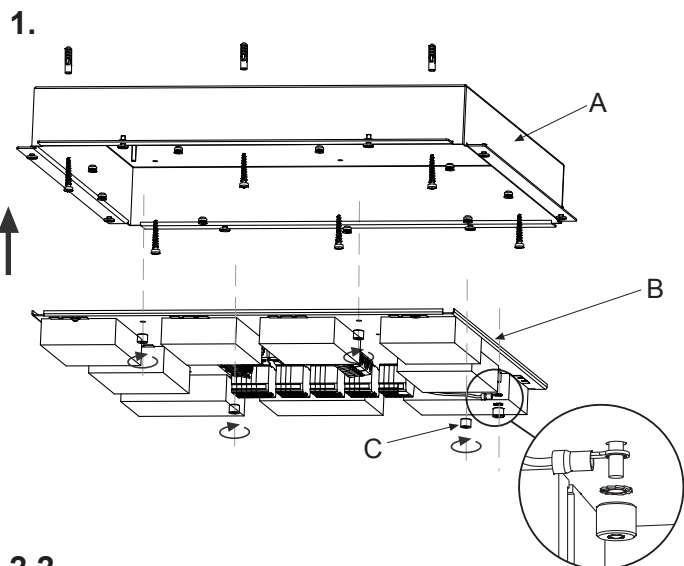

Warning!
Disconnect power supply before installation.

Atención!
Desconectar la conexión a red antes de ser manipulada.

1. Fix the main support (A) to the ceiling using the plugs and screws provided, being sure that the hole of the main support is centered with the outlet box. Attach the electrical union (B) with the nuts (C).

2. Position and install the plate (D) using the screws (E) supplied, as shown in Figs. 2.1 and 2.2. Insert the ground wire into the connector (F).

3. Install the smaller supports (G) and attach each Nenúfar (See the Nenúfar Installation Instructions). Make sure that all the Nenúfar electrical cables are secured as shown in Fig. 3.

4. Make the electrical connections to the main supply. Connect the wiring for each Nenúfar to the multi-socket adaptor (I): Attach the red (or blue) wire to the positive (+ / Red) terminal and the black (or brown) wire to the negative (- / Black) terminal.

5. Attach the cover (J) by means of the screws and washers (K) provided.